

# Viscosity Conversion Table

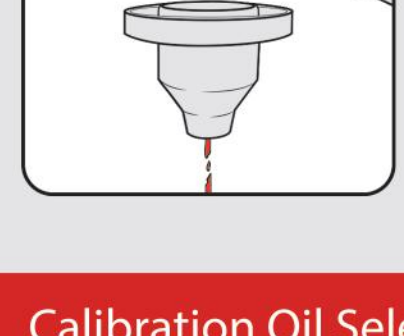

| Formula ISO 2431 - 3:<br>$V = 0.443 \cdot T \cdot \left(\frac{100}{T}\right)^{1.161}$ |              | Formula ISO 2431 - 4:<br>$V = 1.37 \cdot T \cdot \left(\frac{100}{T}\right)^{1.161}$ |              | Formula ISO 2431 - 5:<br>$V = 3.28 \cdot T \cdot \left(\frac{100}{T}\right)^{1.161}$ |                | Formula ISO 2431 - 6:<br>$V = 6.9 \cdot T \cdot \left(\frac{100}{T}\right)^{1.161}$ |                | Formula DIN 53211 - 4:<br>$V = 4.57 \cdot T \cdot \left(\frac{100}{T}\right)^{1.161}$ |                | Formula ASTM D1200 - 1:<br>$V = 0.49 \cdot (T - 35)$ |                | Formula ASTM D1200 - 2:<br>$V = 1.44 \cdot (T - 18)$ |                | Formula ASTM D1200 - 3:<br>$V = 2.31 \cdot (T - 6.58)$ |                  | Formula ASTM D1200 - 4:<br>$V = 3.85 \cdot (T - 4.49)$ |                  | Formula ASTM D1200 - 5:<br>$V = 12.1 \cdot (T - 2)$ |                  | Formula ASTM D1084 - 1:<br>$V = 1.1 \cdot (T - 29)$ |      | Formula ASTM D1084 - 2:<br>$V = 3.5 \cdot (T - 14)$ |       | Formula ASTM D1084 - 3:<br>$V = 11.7 \cdot (T - 7.5)$ |       | Formula ASTM D1084 - 4:<br>$V = 14.8 \cdot (T - 5)$ |       | Formula ASTM D1084 - 5:<br>$V = 23 \cdot (T - 0)$ |      | Formula BS 3900 A6-71 B2:<br>$V = 0.4277T$ |      | Formula BS 3900 A6-71 B3:<br>$V = 0.00027 \cdot 1.3197 \cdot 9.7409$ |      | Formula BS 3900 A6-71 B4:<br>$V = 0.00037 \cdot 2.95387 \cdot 13.362$ |      | Formula BS 3900 A6-71 B5:<br>$V = 0.00057 \cdot 5.81757 \cdot 24.705$ |       | Formula BS 3900 A6-71 B6:<br>$V = 0.00057 \cdot 5.81757 \cdot 24.705$ |       |    |       |     |       |     |        |    |       |     |        |     |        |
|---|--------------|--|--------------|--|----------------|---|----------------|---|----------------|--|----------------|--|----------------|--|------------------|--|------------------|---|------------------|---|------|---|-------|---|-------|---|-------|---|------|--|------|--|------|---|------|---|-------|---|-------|----|-------|-----|-------|-----|--------|----|-------|-----|--------|-----|--------|
| ISO 2431 - 3  | ISO 2431 - 4 | ISO 2431 - 5   | ISO 2431 - 6 | DIN 53211 - 4  | ASTM D1200 - 1 | ASTM D1200 - 2  | ASTM D1200 - 3 | ASTM D1200 - 4  | ASTM D1200 - 5 | ASTM D1084 - 1                                       | ASTM D1084 - 2 | ASTM D1084 - 3                                       | ASTM D1084 - 4 | ASTM D1084 - 5   | BS 3900 A6-71 B2 | BS 3900 A6-71 B3                                       | BS 3900 A6-71 B4 | BS 3900 A6-71 B5                                    | BS 3900 A6-71 B6 |   |      |   |       |   |       |   |       |   |      |  |      |  |      |   |      |   |       |   |       |    |       |     |       |     |        |    |       |     |        |     |        |
| 30  | 6.6          | 30   | 34.4         | 30   | 91.1           | 30  | 188.0          | 25  | 96.2           | 88   | 397.0          | 55   | 9.8            | 40   | 31.7             | 20   | 217.8            | 35  | 6.6              | 20  | 21.0 | 20  | 146.3 | 20  | 222.0 | 20  | 460.0 | 30  | 12.8 | 121  | 51.8 | 212  | 90.7 | 30  | 29.6 | 121   | 339.7 | 212   | 599.4 | 30 | 149.4 | 121 | 671.9 | 212 | 1186.1 | 30 | 622.0 | 121 | 2660.3 | 212 | 4682.1 |

# Calibration Oil Selection Table Rotational @ 20°C

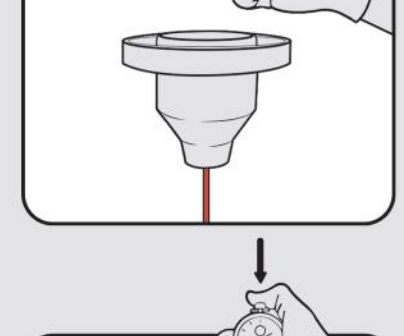
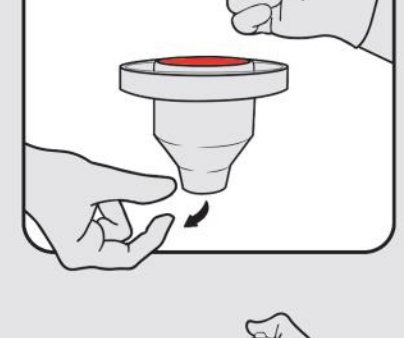
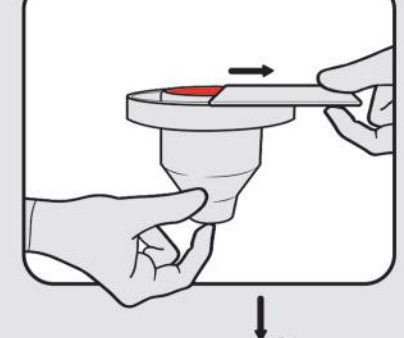
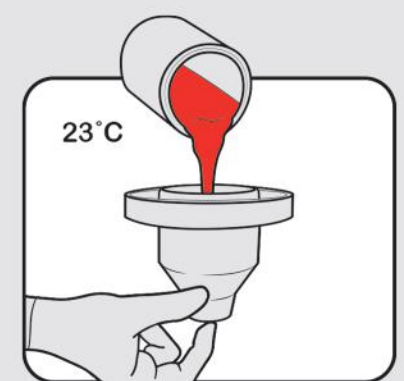
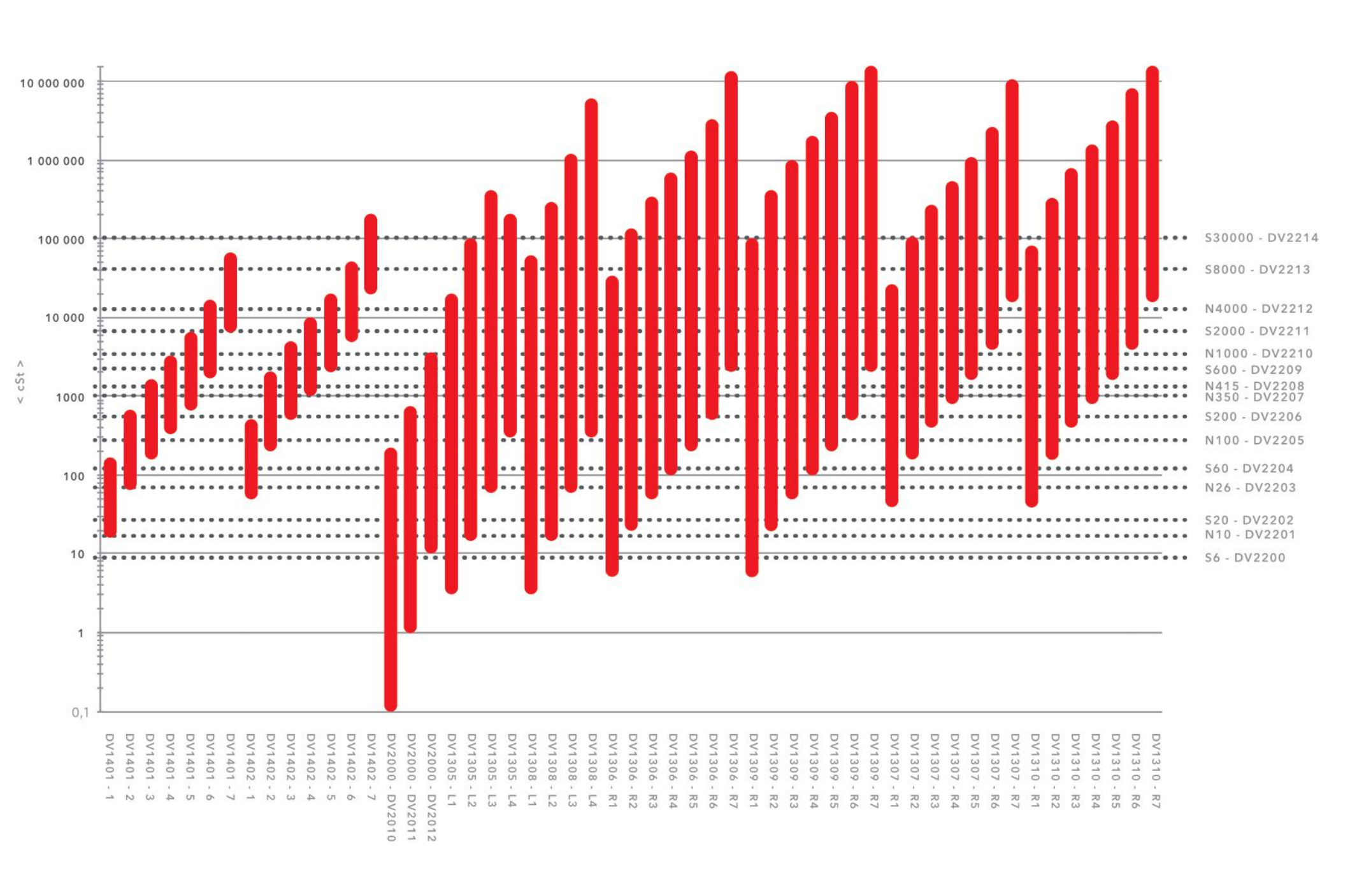

# Viscosity Cups Calibration Oil Selection Table @ 20°C

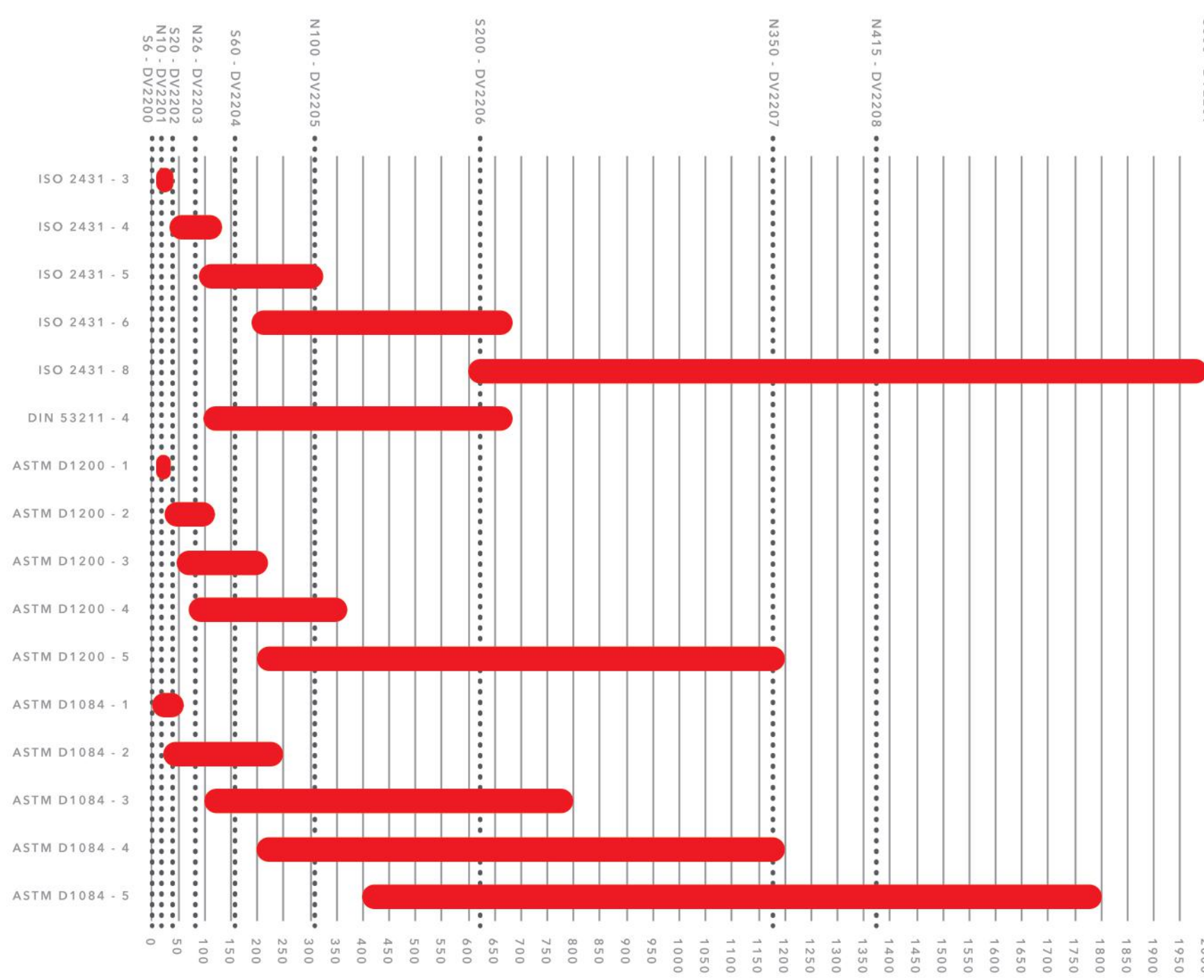

# Oil Selection Table

| TOC Sheen Oil | Paragon Oil | Viscosity for cups in cSt |       | Viscosity for rotational in cP (mPa.s) |       | Specific gravity for calculations in g/ml |        |
|---------------|-------------|---------------------------|-------|--|-------|---|--------|
|               |             | 20°C                      | 25°C  | 20°C                                   | 25°C  | 20°C                                      | 25°C   |
| DV2200        | S6          | 10.55                     | 8.912 | 8.911                                  | 7.428 | 0.8446                                    | 0.8413 |
| DV2201        | N10         | 20.72                     | 16.92 | 16.92                                  | 14.92 | 0.8461                                    | 0.8429 |
| DV2202        | S20         | 42.83                     | 33.76 | 36.35                                  | 28.54 | 0.8487                                    | 0.8455 |
| DV2203        | N26         | 84.16                     | 64.35 | 71.96                                  | 54.81 | 0.855                                     | 0.8518 |
| DV2204        | S60         | 158.5                     | 117.9 | 136.4                                  | 101.1 | 0.8606                                    | 0.8575 |
| DV2205        | N100        | 329                       | 237.4 | 205.1                                  | 158.2 | 0.8669                                    | 0.8638 |
| DV2206        | S200        | 642.1                     | 453.9 | 559.2                                  | 393.9 | 0.8709                                    | 0.8679 |
| DV2207        | N350        | 1179                      | 818.4 | 712.1                                  | 518.1 | 0.8741                                    | 0.8711 |
| DV2208        | N415        | 1531                      | 1051  | 881.1                                  | 631.9 | 0.8741                                    | 0.8711 |
| DV2209        | S600        | 2053                      | 1409  | 1231                                   | 874.9 | 0.8764                                    | 0.8735 |
| DV2210        | N1000       | 4256                      | 2864  | 2516                                   | 1808  | 0.8808                                    | 0.8779 |
| DV2211        | S2000       | 7946                      | 5232  | 4599                                   | 3319  | 0.882                                     | 0.8791 |
| DV2212        | N4000       | 10456                     | 7404  | 6288                                   | 4512  | 0.888                                     | 0.8852 |
| DV2213        | S8000       | 24835                     | 17206 | 14808                                  | 10608 | 0.8907                                    | 0.888  |
| DV2214        | S30000      | 137816                    | 85532 | 76423                                  | 57423 | 0.8962                                    | 0.8962 |

All values stated are nominal values. Actual values can deviate. See supplied certificate for full details.

